

For Immediate Release:

1st LED Exit Sign Retrofit to Receive City of Chicago Approval

In a letter signed by the City of Chicago's Deputy Fire Commissioner Nicholas Russell and Chief Fire Prevention Engineer John Javorka, the Radionic ZXE-5000 Series of LED Exit Sign Retrofit Kits has been approved for use in the City of Chicago.

Designed, engineered and partially assembled in Radionic's Chicago headquarters, the ZXE-5000 makes saving energy easy and affordable for commercial and residential buildings. Each kit features 56 LEDs totaling 5.5 watts and includes several mounting options. The kit is UL-924 and City of Chicago approved (additional cities pending) and has patents pending at the U.S. Patents and Trademark Office. The first in the full line of retrofit kits is compatible with most exit sign housing types including: panel face, recessed, edgelo and surface.

Radionic's engineering team partnered with downtown Chicago building engineers to create a user friendly product that requires minimal installation time. Exit Signs remain *on* 24 hours a day, 365 days/year and are prime candidates for energy saving alternatives.

“In today's economic climate where every penny counts, most commercial and residential buildings can't afford *not* to convert their exit signs to LEDs with Radionic's ZXE-5000,” explains Jeffrey Winton, CEO of Radionic Industries, Inc. “By enabling our customers to keep the existing fixture housing with minimal time and labor involved, we're able to help them save money on the cost of the project as well as their electric bills.”

Reduce Waste and Energy Without Compromising Light Quality:

- * For every 100 exit signs installed, the savings are approximately **\$1,524.00/year (73%)**.
- * No need to change and dispose of the existing exit sign fixture to convert from fluorescent to energy saving LED. (Only change out the fluorescent bulb.)
- * The ZXE-5000 emits light equivalent to a typical fluorescent exit sign lamp.

Radionic's ZXE-5000 retrofits are already installed in several high profile downtown Chicago buildings. When installed, residents and tenants don't know there has been a change. *The only difference you will see is the substantial savings on your electric bills.*

The ZXE Series' power supply, also designed in Radionic's Chicago engineering lab, has been used in the LED marketplace for over 5 years.

Radionic Hi-Tech, Inc. designs, engineers and manufactures lighting fixtures for many of the industry's leading OEM's in North America. Founded in 1939, Radionic manufactures a full line of fluorescent lamp ballasts and fixtures and has enjoyed a strong quality and service reputation for nearly 70 years.

The kits will be in stock in early December; Orders are now being accepted. For complete specifications visit www.radionic.net/ZXE_5000.pdf. For orders under 100 pieces, visit www.FactoryDirectLighting.net. For more information or volume pricing contact: (773) 804-0100 or sales@radionic.net.



City of Chicago
Richard M. Daley, Mayor

Chicago Fire Department

John W. Brooks
Fire Commissioner

Fire Prevention Bureau
444 North Dearborn Street
Chicago, Illinois 60610
(312) 744-4723
(312) 744-1876 (FAX)
<http://www.cityofchicago.org>

October 28, 2009

Allison Winton
Senior Project Manager
Radionic Industries, Inc.
6625 West Diversey
Chicago, Illinois 60707

Subject: LED Retrofit Kit

Dear Ms. Winton:

Based on the recent testing information from Underwriters Laboratories that you have provided, the Radionic LED exit sign retrofit kit shall be acceptable for use in the City of Chicago. This kit uses white LED lamps as the light source.

The retrofit kit has only been tested in Western Lighting and Alkco Lighting fixtures. Therefore, at this time, the retrofit kit can only be used in signs produced by those two companies.

As a reminder, the City of Chicago code requires exit fixtures to use red letters on a white translucent field. Chevrons are not acceptable and full-length arrows must be used for directional signs.

Sincerely,

A handwritten signature in cursive script that reads "Nicholas Russell".

Nicholas Russell
Deputy Fire Commissioner

A handwritten signature in cursive script that reads "John Javorka".

John Javorka, P.E., LEED AP
Chief Fire Prevention Engineer



ZXE-5000

The first UL-924 LED Exit Sign Retrofit Kits approved for use with Edgelit and Sign Box styles.



Save Energy

Save Money

Reduce Waste

Retrofit your exit signs with Radionic's ZXE-5000 Kits.

- Easy to Install: Splice into existing wires.
- UL-924 and City of Chicago approved (additional cities pending)
- No need to compromise light and aesthetics to save energy – looks the same as fluorescent.
- 5-year Warranty
- Patent Pending
- Designed in Chicago, IL USA
- Lighting fixture extrusion made of recycled aluminum
- 73% Energy Saving*

\$ Savings per Year

73% Energy Savings* - compared to conventional fluorescent Exit Sign

*Based on a rate of 50.12/KW

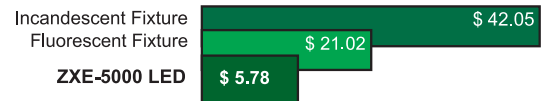

Energy Cost per Year/Fixture

ZXE-5000-I

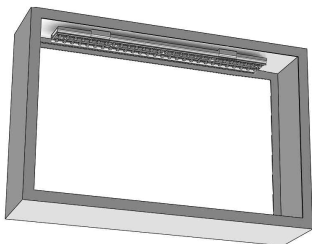

ZXE-5000 Specifications:

Model #:	Description:	Wattage & Efficacy:	For use with Exit Signs
ZXE-5000-I	LED Retrofit Kit with Internal Power Supply; LENGTH: 9"	5.5 Watts 66 Lumens/W	Sign Box style
ZXE-5000-E	LED Retrofit Kit with Remote Power Supply (power supply is mounted in sign box housing, separate from LED source); LENGTH: 9"	5.5 Watts 66 Lumens/W	Edgelit and Sign Box styles

ZXE-5000-E

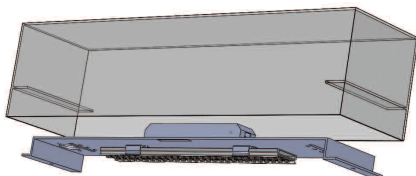

RADIONIC
HI-TECH, INC.

6625 W. Diversey Avenue, Chicago, IL 60707

phone: (773) 804-0100, fax (773) 804-0180 www.radionic.net

In keeping with our commitment to sustainability, this document was printed on recycled paper.